

TBASCO

Thunder Bay Australian Shepherd Club of Ontario

1 All-Breed Ranch Trial (s) & 1 All-Breed Farm Trial (s)***pending ASCA approval*

May 22nd & 23rd, 2021

Tucker Creek Farm, 3020 Hwy 61, Slate River (Thunder Bay), Ontario, Canada

****ASCA® Sanction Pending****

Limited Entry*

Judges:

Kim Schneider-Torson, ASCA Stock dog judge, Minnesota
Emergency Judge (if travel restrictions are still in place): Annie Otto

Handler's Meeting 9:00 AM, start directly after at Tucker Creek Farm starting with sheep Farm Trial. Run Order will be drawn and posted day of trial.

Saturday, May 22nd

a.m. **Trial #1 – Farm Trial Sheep:**
Sheep Farm Trial (Open & Advanced) Judge: Kim Schneider

Sunday, May 23rd

a.m. **Trial #2 – Ranch Trial Sheep:**
Sheep Ranch Trial Judge: Kim Schneider

Stock Entry Fees (Cdn or US\$ accepted:

	<u>Pre-Entry</u>	<u>Gate</u>
Sheep Ranch Trial	\$20.00	\$25.00
Sheep Farm Trial	\$20.00	\$25.00

Livestock:

Sheep Farm: 10 Head Limited 10 Max Runs per trial***
Sheep Ranch: 10 Head Limited 10 Max Runs per trial***

Course Director: **Madison Wheeler** tbay.wheeler@gmail.com 807-633-4731

Entries Open: April 30th, 2021

Pre-Entries must be RECEIVED by: May 15th, 2021

Send Entries to:

Madison Wheeler
3020 Hwy 61
Slate River, ON P7J 0G8

Make cheques payable to: TBASCO

tbay.wheeler@gmail.com
(807) 633-4731

ASCA Stockdog Entry forms are available at www.asca.org
Arena / PATD Entry forms also available on the TBASCO website.

◀ **Daily Awards:** High in Trial Farm Trial – Sheep, High in Trial – Sheep Ranch

Additional Information

Check-In 8:00 AM / Day of Show Entries (if trial not filled) **Close at 9:00 AM**

(We request any substitutions/corrections be made the night before where possible)

Bitches in season run last, out of courtesy to other competitors – ***please notify trial secretary as early as possible.***

*****Limited Entry Stock Trial:**

Limited by number of runs the judge is permitted to judge in a day, and by stock limits. A waiting list will be made in order of receipt if trial fills. Please include your email address on entry (or enclose a self addressed stamped postcard if you do not have email) so we can confirm if you are accepted or on the waiting list.

Gate entries will be accepted as detailed above. Run Order will be determined on day of trial.

Substitutions allowed; No refunds unless slot is filled by another dog.

No entry shall be accepted from a dog or handler disqualified from the ASCA Conformation program, a dog or handler disqualified from all ASCA programs, or a person not in good standing with ASCA.

****Note: Non-ASCA registered Aussies and other herding breed stock competitors:**

You must have an ASCA Tracking number ("this is a number with which ASCA tracks your competition legs earned") to run your dogs. You may get the form and information to obtain that number from the ASCA Website. <http://www.asca.org/Portals/0/trackapp.pdf>

- These events held under the current Rules and Regulations of ASCA®.
- No entry shall be accepted from a dog or handler disqualified from ASCA programs or a person not in good standing with ASCA.
- Local accommodations, RV Park Listings, & nearby Services listings available on <https://www.facebook.com/groups/1752853158282156/>
- Lunch will not be available to purchase on site, please bring your own.
- Veterinarian: Northwest Veterinary Hospital: 1160 Oliver Rd, Thunder Bay
807-345-3353 (after hours 807-623-7451)

Directions to Tucker Creek Farm: GPS 48.308, -89.391

From Thunder Bay: head south on Highway 61 towards the US border. We are 6.5 miles / 10.5 km past the airport, 1 km past the Neebing Roadhouse. We are the first driveway on the right hand side just past Re-Cool Recycling and across from DeBruins Nursery.

From the US border, heading north on Highway 61 we are approximately 28 miles / 46 km from the border towards the city of Thunder Bay. The address is 3020 Highway 61, on the left, just after you pass Gillespie Road, and opposite DeBruins Nursery. If you see the "Welcome to Thunder Bay" sign you have just passed our driveway. ☺

Please pull off the sides of the driveway. Please pick up after your dogs and put the bags in the garbage cans provided. There will be either a luncheon or concession for the trials. BBQ, snacks and refreshments will be available for sale.

Farm Trial Course Descriptions

10 head of sheep per run

1. 10 head of sheep will be set out into the arena while handler and dog wait at the cone.
2. Dog will complete a 150' gather in arena
 - a. For Advanced, the handler must stay at cone for full 150'
 - b. For Open, handler may go 50% of the distance for a send at 75'

3. Bring all sheep to pen A and into Pen B
4. Complete a hold in area in pen B
 - a. For Open, handler may utilize and stay against the fence
 - b. For Advanced, handler must be off the fence while the dog holds the stock in the marked area
5. Bring stock into Pen A and move to the chute
6. Send the stock into the chute while the end gate is closed and “mark” the sheep using the crayon provided to simulate vaccinations
7. With the dog creating side and rear pressure release the sheep from the chute to Pen A.
8. Move sheep from Pen A to Arena
9. Bring sheep to Pen C and sort off 5 sheep – sort can take place using either gate on Pen C
 - a. For Open, must sort 3 marked head and any 2 remaining sheep to make up 5 sorted sheep
 - b. For Advanced, must sort 5 marked head
10. 5 sorted sheep will be moved to Pen D and then into Pen E
11. Remaining 5 sheep will be moved to Pen D and then into Pen E with the previously sorted sheep
12. Time stops when all 10 sheep are back in Pen E and gate is closed

Farm Trial Course Diagram

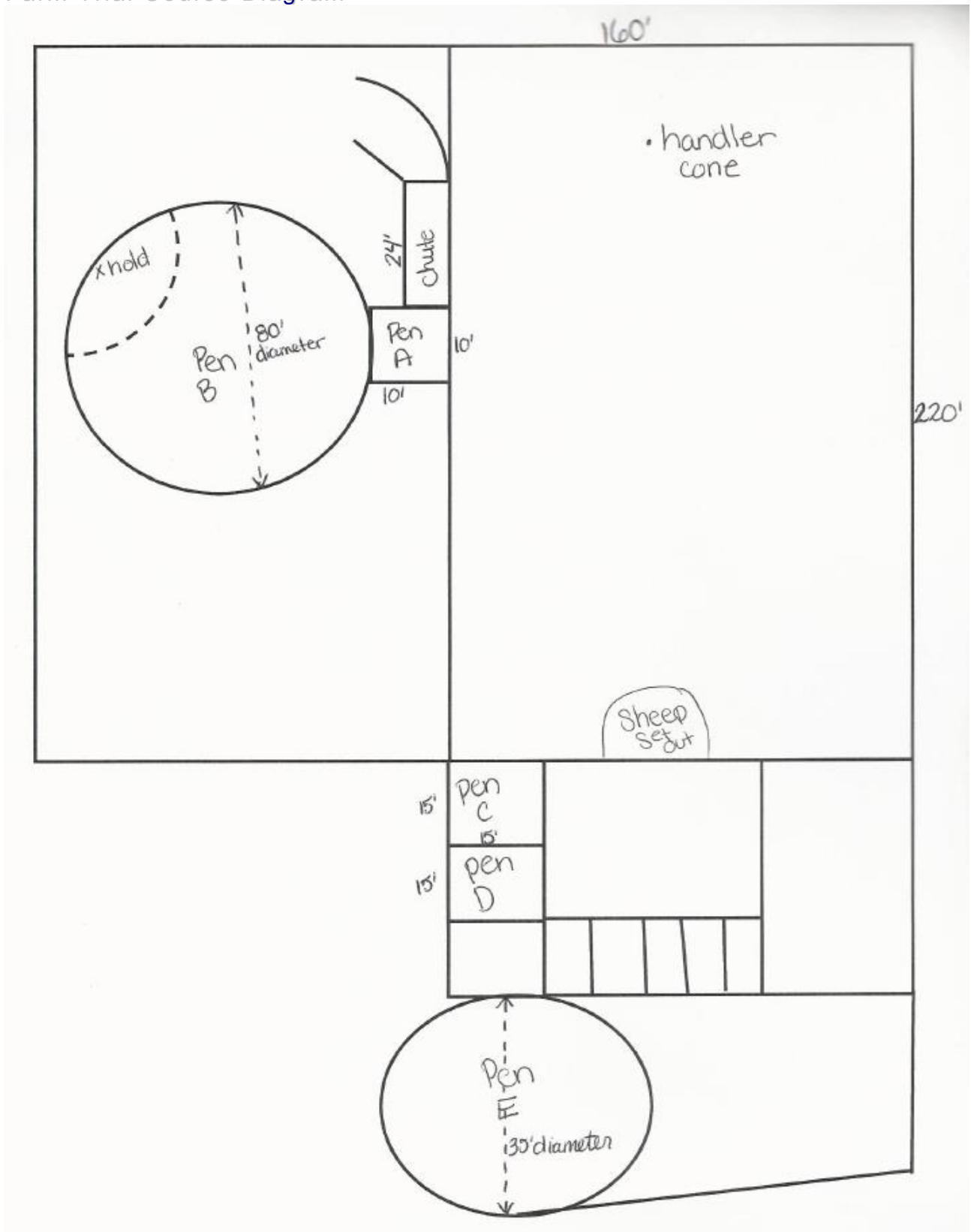

Ranch Trial Course Descriptions

10 head of sheep per run

1. Dogs will take sheep out of Pen A into arena
2. They will drive the sheep (approximately 200') from the gate of Pen A up to the gate to Field 1
3. Sheep will be set out to Field 1 and dog called off
4. Once dog is back to handler, they will send the dog on a gather (approximately 150') into Field 1 to bring sheep back into arena
5. Sheep will be moved to Pen B
6. From Pen B sheep will be moved to the chute
7. Sheep will be put into the handling chute and then be sorted
 - a. 3 marked head and 2 remaining sheep will be sorted for a total of 5 sorted sheep
 - b. The sort will be completed using the handling chute
8. Sorted sheep will be moved into Pen C from chute
9. Remaining sheep will be placed in Pen B
10. All sheep will be put back together and brought back into arena
11. All 10 sheep will be brought down and exhausted into Pen D
12. Time stops when the gate is closed on Pen D

Ranch Trial Course Diagram

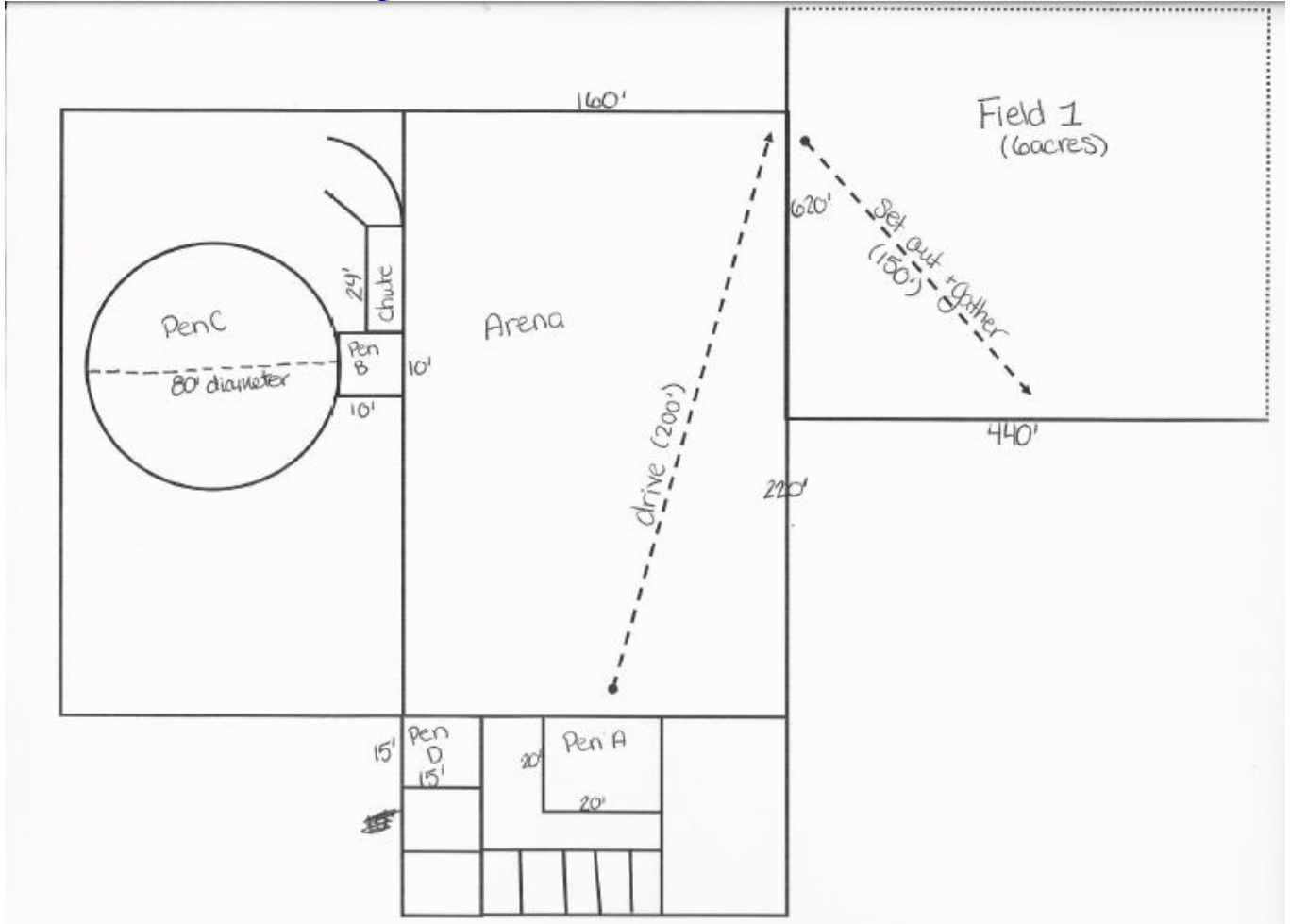

TBASCO is the Thunder Bay Australian Shepherd Club of Ontario,
an affiliate club of ASCA (Australian Shepherd Club of America).

TBASCO is an ALL-BREED / MIXED-BREED club. New members welcome.

Visit our Facebook pages at

<https://www.facebook.com/groups/1752853158282156/>