

TBASCO

Thunder Bay Australian Shepherd Club of Ontario

3 All-Breed Farm Trials (s/d/m), 5 All-Breed Stock Dog Trials (scd)
including PATD (s) **pending ASCA approval

July 15th - 18th, 2021

Tucker Creek Farm, 3020 Hwy 61, Slate River (Thunder Bay), Ontario, Canada

****ASCA® Sanction Pending** Limited Entry***

Judges:

Tanya Wheeler, ASCA Stock judge, Ontario
Kim Schneider, ASCA Stock Judge, Minnesota
Jan Wesen, ASCA Stock Judge, Washington

Annie Otto - Emergency Judge

Jack Hansen – Emergency Judge

Handler's Meeting 8:30 AM, start directly after at Tucker Creek Farm. Run Order will be drawn and posted day of trial.

Thursday, July 15th

a.m.	Trial #1 – Farm Trial Ducks: Duck Farm Trial (Open & Advanced)	Judge: Kim Schneider
p.m.	Trial #2 – Farm Trial Mixed (S/D): Mixed Farm Trial (Open & Advanced)	Judge: Kim Schneider

Friday, July 16th

a.m.	Trial #3 – Farm Trial Sheep: Sheep Farm Trial (Open & Advanced)	Judge: Jan Wesen
p.m.	Trial #4 – Arena Trial scd: Sheep ASCA Course E Ducks/Geese ASCA Course A Cattle ASCA Course B	Judge: Tanya Wheeler Judge: Tanya Wheeler Judge: Tanya Wheeler

Saturday, July 17th

a.m.	Trial #5 – Arena Trial scd: Sheep ASCA Course E Sheep ASCA PATD Course A Ducks/Geese ASCA Course A Cattle ASCA Course B	Judge: Kim Schneider Judge: Kim Schneider Judge: Kim Schneider Judge: Kim Schneider
p.m.	Trial #6 – Arena Trial scd: Sheep ASCA Course E Sheep ASCA PATD Course A Ducks/Geese ASCA Course A Cattle ASCA Course B	Judge: Jan Wesen Judge: Jan Wesen Judge: Jan Wesen Judge: Jan Wesen

Saturday, July 17th

a.m.	Trial #7 – Arena Trial scd:	
	Sheep ASCA Course E	Judge: Kim Schneider
	Sheep ASCA PATD Course A	Judge: Kim Schneider
	Ducks/Geese ASCA Course A	Judge: Kim Schneider
	Cattle ASCA Course B	Judge: Kim Schneider
p.m.	Trial #8 – Arena Trial scd:	
	Sheep ASCA Course E	Judge: Jan Wesen
	Sheep ASCA PATD Course A	Judge: Jan Wesen
	Ducks/Geese ASCA Course A	Judge: Jan Wesen
	Cattle ASCA Course B	Judge: Jan Wesen

<u>Stock Entry Fees</u> (Cdn or US\$ accepted:	<u>Pre-Entry</u>	<u>Gate</u>
Sheep	\$45.00	\$50.00
Ducks/Geese	\$35.00	\$40.00
Cattle	\$50.00	\$60.00
Open Working Junior	\$30.00	\$35.00
Working Junior	\$20.00	\$25.00
Sheep Farm Trial	\$50.00	\$55.00
Mixed Farm Trial	\$50.00	\$55.00
Duck Farm Trial	\$50.00	\$55.00
PATD Sheep	\$50.00	\$55.00

Livestock:

Sheep Farm: 10 Head	Limited 10 Max Runs per trial***
Mixed Farm: 10 Head (s) & 5 Head (d)	Limited 5 Max Runs per trial***
Duck Farm: 10 head	Limited 5 Max Runs per trial***
PATD Sheep: 10 head	Limited 5 Max runs per trial***
Sheep: 3-5 Head	Limited 40 Max Runs per trial***
(Started may be woolies; Advanced and Open may be hair sheep/wool sheep crosses)	
Ducks/Geese: 5 head	Limited 16 Max Runs per day*** Mixed breed ducks/ Geese
Cattle: 3-5 head	Limited 20 Max Runs per day*** Beef Cattle mix

Course Director: **Madison Wheeler** tbay.wheeler@gmail.com 807-633-4731

Entries Open: June 21st, 2021

Pre-Entries must be RECEIVED by: **July 9th, 2021**

Send Entries to:

Madison Wheeler
3020 Hwy 61
Slate River, ON P7J 0G8

Make cheques payable to: TBASCO
tbay.wheeler@gmail.com
(807) 633-4731

ASCA Stockdog Entry forms are available at www.asca.org

< **Daily Awards:** High in Trial Aussie, High in Trial Sheep, High in Trial Cattle, High in Trial Ducks.
High in Trial Farm Trial – Sheep, High in Trial Farm Trial – Ducks, High in Trial Farm Trial – Mixed.

< **Weekend Awards** High Combined WTCH*, High Combined Other Breed*, High Combined Other Breed*, High Combined Farm Trial Dog, Most Promising Started Aussie*, Most Promising Started Other Breed*, High Open Working Junior, High Junior Handler.

* (highest combined qualifying scores from at least 2 different stock, in Arena trials)

Additional Information

Check-In 8:00 AM / Day of Show Entries (if trial not filled) **Close at 8:30 AM**

(We request any substitutions/corrections be made the night before where possible)

Bitches in season run last, out of courtesy to other competitors – **please notify trial secretary as early as possible.**

*****Limited Entry Stock Trial:**

Limited by number of runs the judge is permitted to judge in a day, and by stock limits. A waiting list will be made in order of receipt if trial fills. Please include your email address on entry (or enclose a self addressed stamped postcard if you do not have email) so we can confirm if you are accepted or on the waiting list.

Gate entries will be accepted as detailed above. Run Order will be determined on day of trial.

Substitutions allowed; No refunds unless slot is filled by another dog.

No entry shall be accepted from a dog or handler disqualified from the ASCA Conformation program, a dog or handler disqualified from all ASCA programs, or a person not in good standing with ASCA.

****Note: Non-ASCA registered Aussies and other herding breed stock competitors:**

You must have an *ASCA Tracking number* ("this is a number with which ASCA tracks your competition legs earned") to run your dogs. You may get the form and information to obtain that number from the ASCA

Website. <http://www.asca.org/Portals/0/trackapp.pdf>

- These events held under the current Rules and Regulations of ASCA®.
- No entry shall be accepted from a dog or handler disqualified from ASCA programs or a person not in good standing with ASCA.
- Local accommodations, RV Park Listings, & nearby Services listings available on <https://www.facebook.com/groups/1752853158282156/>
- Lunch will not be available to purchase on site, please bring your own.
- Veterinarian: Northwest Veterinary Hospital: 1160 Oliver Rd, Thunder Bay
807-345-3353 (after hours 807-623-7451)

Directions to Tucker Creek Farm: GPS 48.308, -89.391

From Thunder Bay: head south on Highway 61 towards the US border. We are 6.5 miles / 10.5 km past the airport, 1 km past the Neebing Roadhouse. We are the first driveway on the right hand side just past Re-Cool Recycling and across from DeBruins Nursery.

From the US border, heading north on Highway 61 we are approximately 28 miles / 46 km from the border towards the city of Thunder Bay. The address is 3020 Highway 61, on the left, just after you pass Gillespie Road, and opposite DeBruins Nursery. If you see the "Welcome to Thunder Bay" sign you have just passed our driveway. ☺

Please pull off the sides of the driveway. Please pick up after your dogs and put the bags in the garbage cans provided. There will be either a luncheon or concession for the trials. BBQ, snacks and refreshments will be available for sale.

Farm Trial Course Descriptions & Diagrams

Duck Farm Trial – July 15, 2021

Course will use 10 head of Ducks. They will be given 15 minutes to complete the course with a 3 minute warning. Ties will be broken by the sort points and then time.

Advanced

1. Dogs will gather the Ducks in Arena (**Gather: 20 points**)
 - a. The gather is 75ft and the handler must remain at the post to send the dog
2. Ducks will be brought to Pen A to complete the sort of 5 ducks (**Sort: 25 points**)
 - a. Sorting 5 marked ducks in pen
3. Move marked ducks into Pen C (**Pen Work: 5 points**)
4. Bring remaining ducks to chute and put them through the chute using the end with a wing (**Chute work: 20 points**)
5. Ducks are then brought to the footbath simulation (**Footbath: 20 points**)
6. Ducks will be driven the length of the Arena (approximately 100ft) (**Drive: 20 points**)
 - a. Handler will remain at the start of the drive
7. Bring ducks to Pen B, and then back into Arena (**Pen Work: 10 points**)
8. Bring ducks back down to Pen A and then into Pen C with the rest of the ducks (**Pen Work: 10 points**)
9. Time stops when all ducks are in Pen C and Pen C gate is closed

Open

1. Dogs will gather the Ducks in Arena (**Gather: 20 points**)
 - a. The gather is 75ft and the handler move halfway to the stock (approx. 37ft)
2. Ducks will be brought to Pen A to complete the sort of 5 ducks (**Sort: 25 points**)
 - a. Sorting 5 ducks in pen, 3 must be marked and any remaining 2 will do
3. Move marked ducks into Pen C (**Pen Work: 5 points**)
4. Bring remaining ducks to chute and put them through the chute using the end with a wing (**Chute work: 20 points**)
5. Ducks are then brought to the footbath simulation (**Footbath: 20 points**)
6. Ducks will be driven the length of the Arena (approximately 100ft) (**Drive: 20 points**)
 - a. Handler can walk with dog for up to half of drive
7. Bring ducks to Pen B, and then back into Arena (**Pen Work: 10 points**)
8. Bring ducks back down to Pen A and then into Pen C with the rest of the ducks (**Pen Work: 10 points**)
9. Time stops when all ducks are in Pen C and Pen C gate is closed

Diagram 1 – Duck Farm Trial

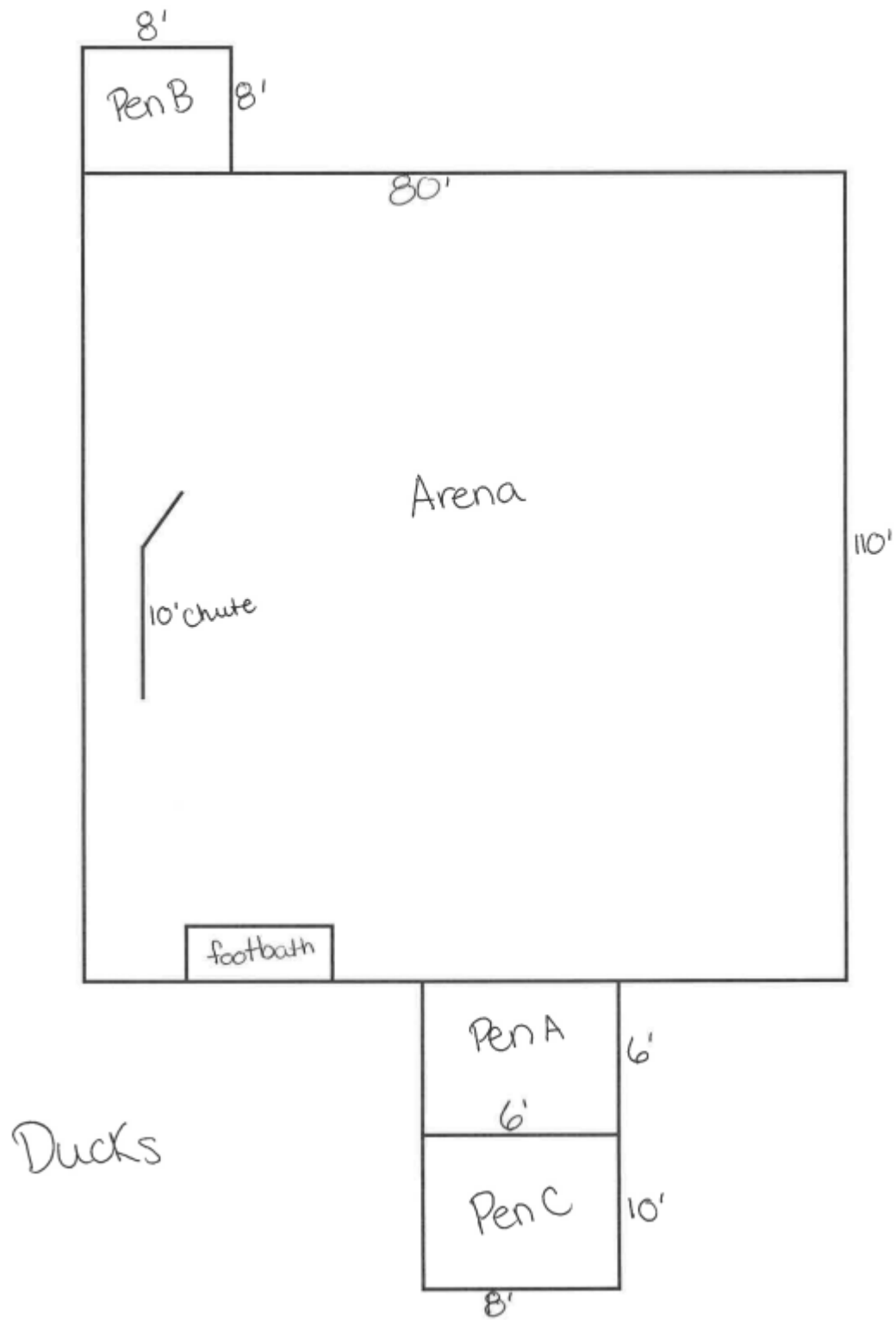

Mixed Farm Trial – July 15, 2021

Course will use 10 head of Sheep and 5 head of Ducks. They will be given 15 minutes to complete the course with a 3 minute warning. Ties will be broken by the sort points and then time.

Advanced

1. Dogs will gather the Ducks in Duck Arena (**Gather: 20 points**)
 - a. The gather is 75ft and the handler must remain at the post to send the dog
2. Ducks will be driven the length of the Arena (approximately 100ft) (**Drive: 20 points**)
 - a. Handler will remain at the start of the drive
3. The ducks will be brought the area of the arena to complete the hold (**Hold: 20 points**)
4. Ducks are brought to Pen E for re-pen (**Pen Work: 5 points**)
5. Teams will move to Pen A and bring sheep from Pen A to Pen B, then to Pen D then to Sheep Arena (**Pen Work: 15 points**)
6. Dogs will bring sheep through chute in Sheep Arena (**Chute: 20 points**)
7. Sheep will be sorted using either gate off pen D (**Sort: 25 points**)
 - a. 5 marked head of sheep are to be sorted
8. Sorted sheep are moved to Pen A, and then remaining sheep are also moved to Pen A
9. Time stops when all sheep are in Pen A and all gates are closed

Open

1. Dogs will gather the Ducks in Arena (**Gather: 20 points**)
 - a. The gather is 75ft and the handler move halfway to the stock (approx. 37ft)
2. Ducks will be driven the length of the Arena (approximately 100ft) (**Drive: 20 points**)
 - a. Handler can walk with dog for up to half of drive
3. The ducks will be brought the area of the arena to complete the hold (**Hold: 20 points**)
4. Ducks are brought to Pen E for re-pen (**Pen Work: 5 points**)
5. Teams will move to Pen A and bring sheep from Pen A to Pen B, then to Pen D then to Sheep Arena (**Pen Work: 15 points**)
6. Dogs will bring sheep through chute in Sheep Arena (**Chute: 20 points**)

7. Sheep will be sorted using either gate off pen D (**Sort: 25 points**)
 - a. 3 marked head of sheep and two others are to be sorted
8. Sorted sheep are moved to Pen A, and then remaining sheep are also moved to Pen A
9. Time stops when all sheep are in Pen A and all gates are closed

Diagram 2 - Mixed Farm Trial

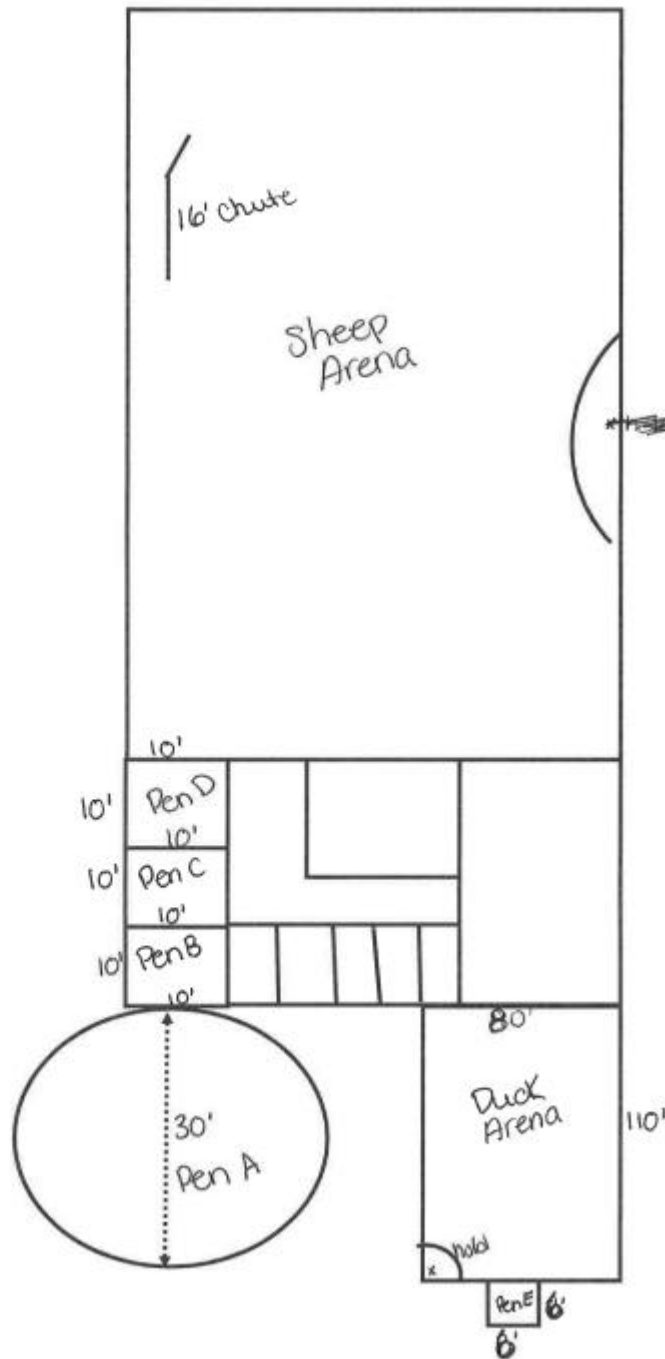

Course will use 10 head of Ducks. They will be given 20 minutes to complete the course with a 10 minute warning. Ties will be broken by the sort points and then time.

Advanced

1. Dogs will gather the Sheep in the Arena (**Gather: 20 points**)
 - a. The gather is 150ft and handler must stay at the handler post
2. Dogs should move sheep from Pen F to Pen E (**Pen Work: 5 points**)
3. Dogs will complete a hold at the designated area (**Hold: 20 points**)
 - a. Handler must be at least 30ft away from the sheep
4. Dog will then move the sheep to Pen F and out to Field 1 (**Pen Work: 5 points**)
5. Dogs will complete a Figure 8 in Field 1 as shown in the course map (**Field work: 20 points**)
6. Dogs will bring sheep back to Pen F and back into Arena (**Pen work: 5 points**)
7. Sheep will be put through the chute in the arena (**Chute: 20 points**)
8. Sheep will be sorted using either gates in Pen D (**Sort: 25 points**)
 - a. 5 marked head will be sorted
9. Sorted sheep will be moved to Pen A and then remaining sheep moved to Pen A (**Pen work: 10 points**)
10. Time stops when all stock are in Pen A and all gates are closed and latched

Open

1. Dogs will gather the Sheep in the Arena (**Gather: 20 points**)
 - a. The gather is 150ft and handler may go half way to the stock (75ft)
2. Dogs should move sheep from Pen F to Pen E (**Pen Work: 5 points**)
3. Dogs will complete a hold at the designated area (**Hold: 20 points**)
 - a. Handler may be with the sheep
4. Dog will then move the sheep to Pen F and out to Field 1 (**Pen Work: 5 points**)
5. Dogs will complete a Figure 8 in Field 1 as shown in the course map (**Field work: 20 points**)
6. Dogs will bring sheep back to Pen F and back into Arena (**Pen work: 5 points**)
7. Sheep will be put through the chute in the arena (**Chute: 20 points**)
8. Sheep will be sorted using either gates in Pen D (**Sort: 25 points**)
 - a. 3 marked head and 2 others will be sorted

9. Sorted sheep will be moved to Pen A and then remaining sheep moved to Pen A
(Pen work: 10 points)

10. Time stops when all stock are in Pen A and all gates are closed and latched

Diagram 3 - Sheep Farm Trial

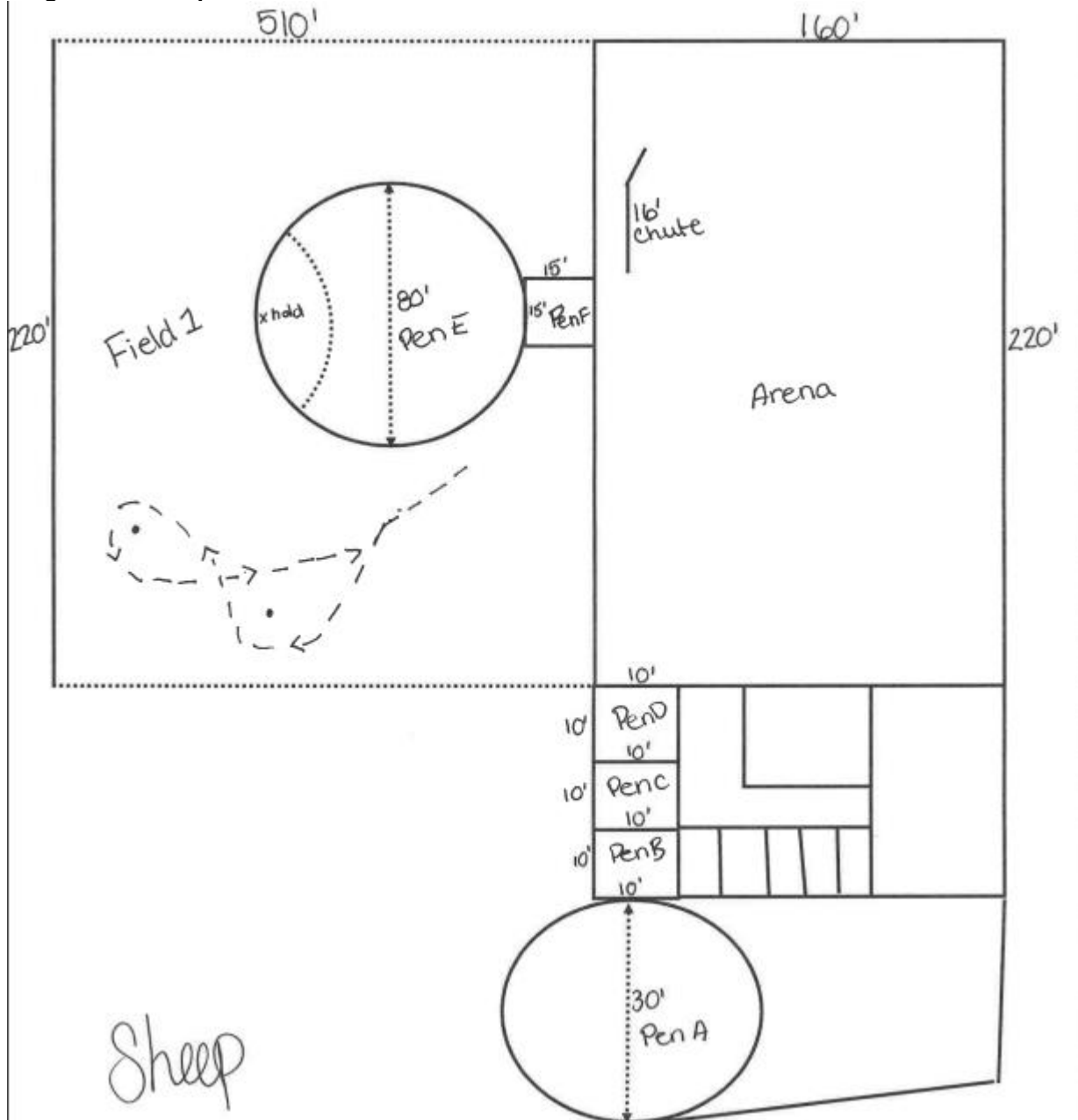

TBASCO is the Thunder Bay Australian Shepherd Club of Ontario,
an affiliate club of ASCA (Australian Shepherd Club of America).
TBASCO is an ALL-BREED / MIXED-BREED club. New members welcome.
Visit our Facebook pages at
<https://www.facebook.com/groups/1752853158282156/>

