

CORONA CLASSIC



****ASCA SANCTIONING PENDING****

**4 ASCA ARENA TRIALS and 1Day Farm trials!
Weekend High Combined Buckle Awards
June 21-23, 2024**

All ASCA Stock Trial Rules will be followed.
Open to all ASCA Recognized Herding Breeds.

Trial Location: Oslie Farm - W13301 Young Road, Black River Falls, WI 54615

Judges Arena: Marie Murphy T1/T4 & Devona Pierce (T2/T3)

Classes offered: Started, Novice, Open, Advanced, Working Junior, FEO
Cattle & Sheep Course D (counter-clockwise). Ducks course A

Handler's meeting: 7:30 am each day with trial beginning immediately after.

Pre-entry for Australian Shepherds opens May 13th, all other breeds May 20th. Postmark by June 14th

Arena Entries (June 21/22):

Cattle -- Pre-entry: \$55 Gate entry: \$65

Sheep -- Pre-entry: \$45 Gate entry: \$55

Ducks -- Pre-entry: \$35 Gate entry: \$45

Working junior class pre entry discount: \$ 10/class, does not apply to titling classes

Daily Maximum Runs: 20 Cattle, 26 Sheep, 20 Duck. Number of head per run will be 3-5 head sheep and cattle(dog broke beef), 5 head ducks, to be determined by number of entries.

Daily Awards: 1-4 Placement Ribbons ~ HIT Cattle ~ HIT Sheep ~ HIT Duck ~ HIT Aussie ~ MPS ~ HIT Junior - HIT working junior

Please help with arena tear down and Farm trial set up Saturday Night!

Farm Trial Entries (June 23): Judge Devona Pierce.

Cattle -- Pre-entry: \$65 Gate entry: \$75

Sheep -- Pre-entry: \$55 Gate entry: \$65

Ducks -- Pre-entry: \$45 Gate entry: \$55

Handler's meeting: 7:30 am each day with trial beginning immediately after. Walk through to follow

FT Classes offered: Open, Advanced, FEO

8-10 head of stock each class depending on entry numbers. 10 runs Sheep, 12 Duck, 10 Cattle (though totals may be adjusted depending on entries).

Owners of dogs will be held responsible for all injuries to livestock during their runs. Replacement costs will be \$50/duck, \$300/sheep, cattle will be fair market value

All non-ASCA registered Aussies/other herding breeds must have an ASCA Q tracker number.

A set out dog will not be used.

Course Director/entries: Heather Oslie
W13301 Young Rd Black River Falls, Wi 54615
Checks made out to 3 Sheeps ASC
FMI: carmelaussies@hotmail.com

No entries will be accepted if postmarked prior to opening date. No electronic entries. All entries must be on the most current ASCA entry form found at asca.org/wpcontent/uploads/2016/04/stockdogentryform.pdf

Pre-entries close June 14th. Gate entries will be taken prior to the Handler's Meeting each day if trial is not filled. Run order will be drawn prior to trial.

No refunds after closing date unless trial is filled and there is a wait list.

Bitches in season will run in order but must be kept away from the arenas when not running.

: P l e a s e c l e a n u p a f t e r y o u r d o g s

Weekend Buckle Awards: HC WTCH, HC NonWTCH, and HC Started. Weekend buckle awards will use combined scores from all classes of stock over the 3 days of trials. **MUST BE ENTERED IN FARM TRIAL TO QUALIFY.** Buckle eligibility determined by arena trial division.

Thank you to our Buckle sponsors!

HC WTCH sponsored by Robbi and CoreyNorman in memory of WTCH CH AllStar's Brass Knuckles AFTDdsm, BN, RNX, RAX

HC Non WTCH sponsored by Monica's Psychotherapy and Healing, PLLC

HC Started Cowgirl Up Aussies Devona Pierce

Day of Trial Information:

- _Draw (Run Order) will be posted prior to start of trial.
- B_i_t_c_h_e_s_i_n_s_e_a_s_o_n_w_i_l_l_r_u_n_i_n_d_r_a_w_o_r_d_e_r._._
- B_i_t_c_h_e_s_i_n_s_e_a_s_o_n_w_i_l_l_r_e_m_a_i_n_c_r_a_t_e_d_w_h_e_n_n_o_t_c_o_m_p_e_t_i_n_g._._
- _All dogs must be on leash or crated when not competing. (Flex leads are not permitted on the grounds)
- _Harassing of stock will not be permitted - run may be called by judge or stock owner.
- _Changes and/or substitutions, other than natural division progressions, must be submitted to the trial secretary in writing the evening before the trial.
- _Move-ups are allowed with written notification to the trial secretary prior to the start of the trial.
- _Entry fees will be refunded only when a dog has been certified by a licensed veterinarian as unable to compete due to sickness or injury. Owner will be responsible for all vet fees.
- _All entries must be on ASCA® entry forms with proper fees included.
- _Please use one entry form per dog.
- _Note that the T1, T2, or T3 designation on a trial does not indicate or restrict the order in which the trials will be held.
- _If the trial is full and you wish to sell a run and there is a waiting list, the transaction must be handled by the trial secretary. All offers to sell runs must be submitted in writing at least one hour before the trial starts. No exceptions.
- _Selling runs individual to individual will not be permitted.
- **_Run limits and judging assignments are subject to change.**

Miscellaneous Items:

- _All ASCA® rules will be strictly enforced.
- _Individuals will be responsible for any damage done to the stock and /or equipment. ASCA®, 3 Sheeps Australian Shepherd Club, and its club members will not be responsible for any loss, damage or injury to persons, dogs or equipment of any competitor or spectator.
- **_Local Vet:** Allied Emergency Vet Service: 2135 N Clairemont Ave., Eau Claire, WI 54703 / 715-529-5900

Camping on grounds available by appointment. No plug ins available.

Motels:

**AmericInn by
Wyndham**
Black River Falls,WI
715-284-3320

Country Inn & Suites
Black River Falls, WI
715-670-3010

**Sure Stay Plus
Hotel by Best
Western**
Black River Falls, WI
715-284-9471

****It has been confirmed, all hotels listed below are dog friendly. Please do your own due diligence when making reservations. There are several campgrounds in the area.

Farm Duck Trial

Today we have to take the ducks off of their pasture pond, sort them out, and treat them for parasites then put them back out to their pasture pond.

1. **Gather (20pts)** the ducks off of their "pond" through gate 1. Task starts when the dog is sent and ends when ducks are in the pasture.
 - Advanced: Handler must send their dog from behind cone 1, but may help, if needed, after the send
 - Open : Handler leaves the dog at cone 1 then may move to cone 2 before sending the dog
2. **Pasture (part #1 10pts)**: Move the ducks through pasture and through Gate #2(end)
3. **Barn Pen Work (Part #1 10pts)**: Move ducks into **Barn Pen**, closing gate, then to the sort area
 - Starts when ducks are through gate#2 and ends with ducks in Barn Pen near sort gates.
4. **Sort 5 (25pts)**: ducks into left hand pen, and 3 into right hand pen. Sort starts with ducks near sort area and ends with ducks in designated pens with gate closed
 - Advanced: sort 5 marked ducks into left hand pen
 - Open: gate sort
5. **Barn Pen Work (Part#2 5pts)**: Move ducks though left hand pen to chute gate. Start when dog enters pen. Ends when chute gate is opened.
6. **Chute(20pts)**: Move ducks into chute. End gates are closed while parasite dust is applied. Release ducks into right hand pen. End when the ducks are all in right hand pen.
7. **Barn Pen work (Part #3 10pts)**: Move ducks from **Right Hand Pen** back into **Barn Pen** and out Gate #3. Close gate(end)
8. **Pasture (part #2 10pts)**: (start)move stock from gate #3 through gate #1.(end)
9. **Drive(20pts)** ducks back to their pond. Starts when ducks are through gate#1, ends with ducks at pond and the dog called off.
 - Advanced: ducks must reach cone 2 before the handler can move freely to help dog
 - Open: no restriction other than must be in a drive position. (parallel ok)

Time ends when the dog is called off. If the dog turns back to stock, time will restart until call off is complete.

Tie Broke by Sort then Gather
13 minutes warning at 3 minutes
Barn pen is used twice

Cattle and Sheep (same course both species) farm trials

Today we have to take the stock off of the grazing pasture, sort them out, and load them through a chute into a trailer, then move them back up to their grazing pasture.

1. **Gather(20pts)** the stock off of grazing area to gate #1. Task starts when the dog is sent and ends when stock are at gate #1
 - Advanced: Handler must send their dog near gate #1, but may help, if needed, after the send
 - Open : Handler leaves the dog at gate then may move to cone 1 before sending the dog
2. **Pasture Work (Part #1 10pts)** move stock through the pasture to gate #2). Task starts when stock are through gate #1 and ends when they are through gate #2
3. **Pen (Work Part #1 10pts):** Move stock into **Pen#1** and close Gate#2.
 - Starts when through gate #2 and ends with stock near sort gates.
4. **Sort 5 (25pts)** sort 5 head into **pen #2** and remaining head into **pen #3** (no order preference/any gates) Sort starts with stock near sort area and ends with stock in designated pens with gates closed
 - Advanced: sort 5 marked stock into pen #2
 - Open: gate sort
5. **Trailer Loading Chute(20pts):** move stock from **Pen#2** into loading chute and onto trailer. Close door and let stock settle. Reopen door and take stock off trailer, through chute and back into pen #2. Side door is available to use for safety. Starts and ends with stock in pen#2
6. **Pen work (Part #2 15pts):** Move stock from **Pen#2(start)** and **pen#3** back into **Pen#1** then move stock from Pen #1 through gate #2 to pasture(end)
7. **Pasture (part #2 10pts):** move stock from gate #2(start) through gate #1(end).
8. **Drive(20pts)** stock back to the pasture holding pen. Starts with stock through gate #1, ends with stock in the pasture pen and gate closed.
 - Advanced: stock must reach cone 1 before the handler can move freely to help dog with final gate
 - Open: no restriction other than must be in a drive position. (parallel ok)

Sheep 15 minutes with warnings at 3 minutes/ cattle 23 min with warning at 5minutes

Tie Broke by Sort the Gather
Pen #1 is used twice

Duck Diagram

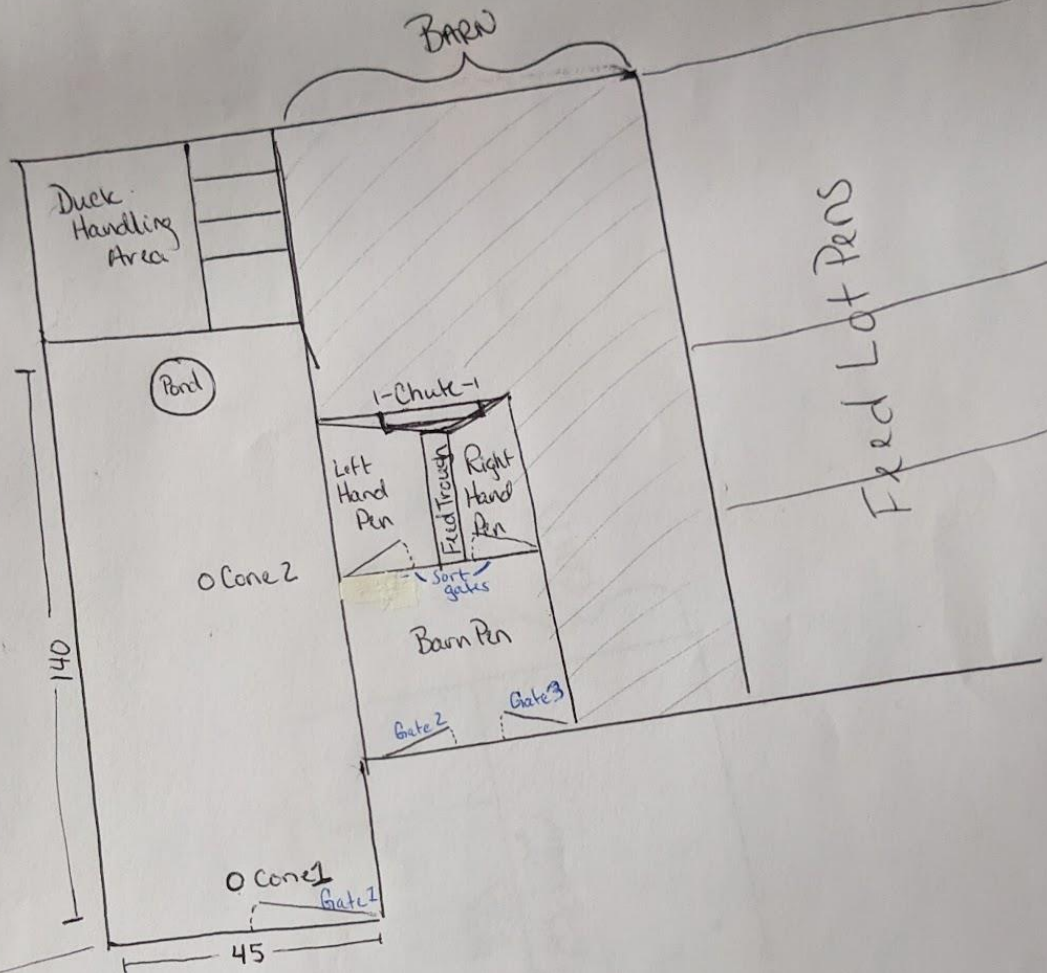

Field/Pasture

BARN Pen = 36 x 41 ft
Right + Left Hand Pens = 32 x 16 ft
Chute = 2 x 8 ft

08/20/2014	10/20/2014	10/20/2014	10/20/2014
Pen	Pen	Pen	Pen

Fire escape area

Arena 0 con

Cattle + Sheep Diagram

448ft

Pasture/Field

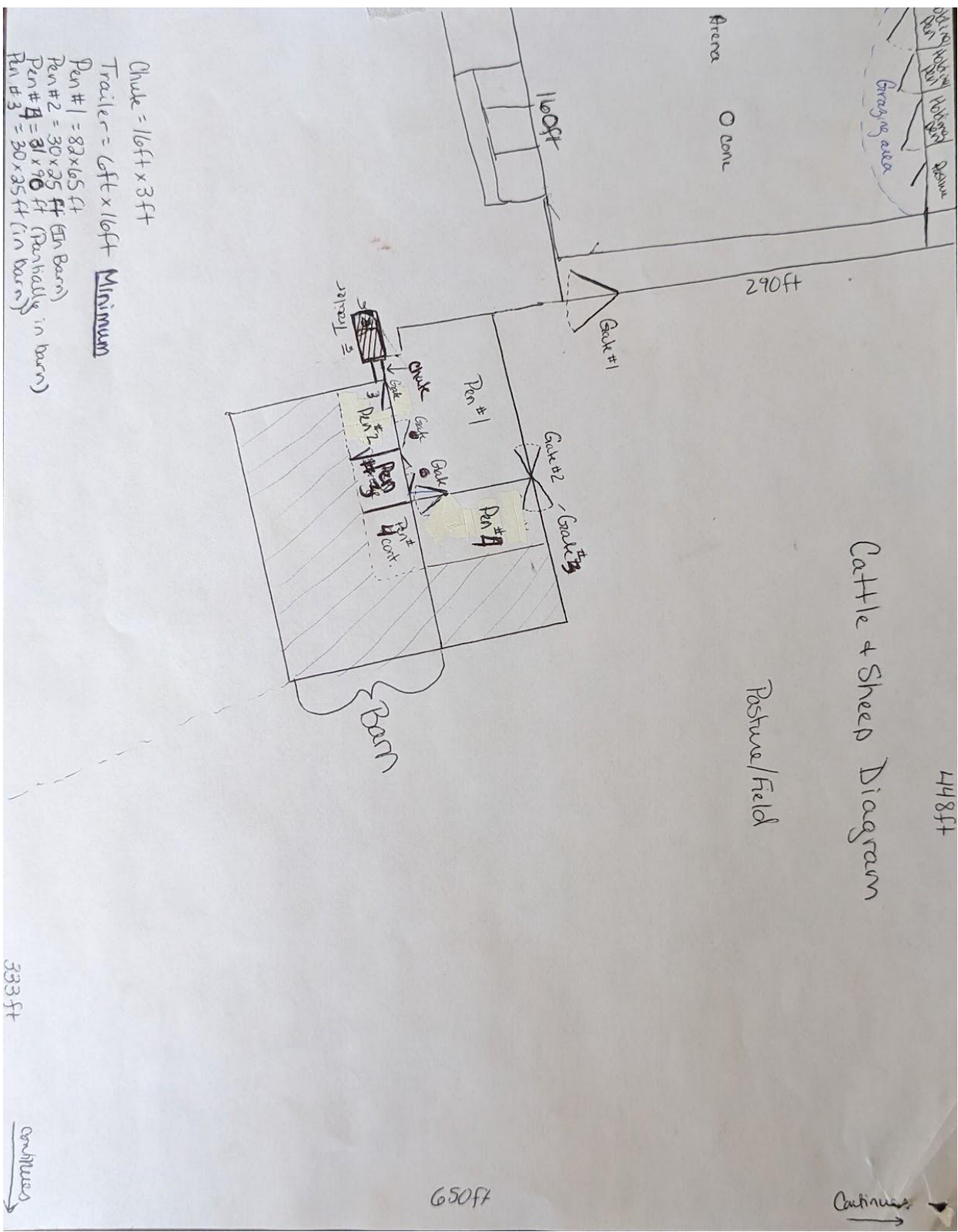

Chute = 16ft x 3ft

Trailer = 6ft x 16ft Minimum

Pen #1 = 82 x 65 ft

Pen #2 = 30 x 25 ft (in barn)

Pen #3 = 31 x 96 ft (Partially in barn)

Pen #4 = 30 x 35 ft (in barn)